



Congratulations on your decision to purchase a Tactical Trap. You've made a wise choice and we're grateful you've given us the opportunity to serve you as a customer. If you have any questions about your product don't hesitate to contact our support team via email at support@tacticaltraps.com. Please read the following for instructions, setup and use.

Step 1: What's Included



Mounting
screws



LED light



Foam pad



Backup
battery pack

If your package is missing any of these items, please email us at support@tacticaltraps.com

Step 2: How The Guardian MAX Mirror Works

Your Guardian MAX is equipped with an RFID locking system and there are two ways to open the unit. One is with your phone via the secured Bluetooth APP. Instructions on that further below.

The second way is with your fingerprint. Since we don't have access to your fingerprint the unit is now set to public mode, meaning any fingerprint can open it. To open the mirror, place your finger on the biometric reader located on top of the frame. The lock will beep and automatically disengage, and the mirror will open on its own when it's on the wall. When it's on its back you might have to give it a little lift but once the shocks engage it will pop up by itself.

To close the mirror, wait 3 seconds for the latch to reengage, the internal pin will automatically come back out of the lock, and then just gently push the top of frame back down until it clicks.

Step 3: Programming The Biometric Fingerprint Reader

When you first get your unit, it will open with any fingerprint. You don't want to leave your lock in public mode like it is now, so your next step is to program it to your fingerprint so only you or whoever else you want can open it. Here's how to do that quickly and easily...

PROGRAMMING THE TACTICAL TRAPS BIOMETRIC LOCK:



Note: Reset is the red arrow. Button 3 is the green arrow. Button 1 is the yellow arrow.

Locks before June 2023

- Reset the lock – Using a paperclip, press and hold the “Reset” button for 2 seconds. Lock will beep 3 times.
- Set Lock into auto lock mode – Using a paperclip, press and hold button 3 for 2 seconds. Lock will beep twice
- Setup Manager’s fingerprints
 - a. Using a paperclip, press and hold button 1 for 1 second. Lock will beep once
 - b. Input the managers fingerprint 5 times
 - c. Managers fingerprint must be setup first before any users. Lock can store up to 100 user fingerprints

Setup User fingerprints

- a. After managers fingerprints are setup, press and hold button 1 again for 1 second. Lock will beep once
- b. The manager must input their fingerprint once, then immediately after have the user input their fingerprint 5 times
- c. For more than one user, repeat step “b” above to add up to 99 more users

Locks from June 2023 to present:

Programming your fingerprints has been simplified.

- 1). You will press button 1, the lock will beep once and you will then scan your manager print 5 times. The manager print is now programmed. Make sure to test your finger print before closing the unit.
- 2). Add up to 99 user prints by pressing button one and then scan the manager print once and the new print 5 times.

With the unit open, test the lock with your fingerprint. If the lock isn't responding repeat the programming instructions. Also, it's a good idea to program the finger you'll be using to open the unit at least 4X as a different user. Why? The reader will only read your fingerprint if it's placed the exact same way you programmed it. That's fine if you place your finger on the reader the same way every time. Not likely. So, program your same finger offset to the left a little. Then offset to the right a little. Then towards the top a little. And then towards the bottom a little...each time as a different user. This will ensure your unit will open on the first try every time.

Congratulations, your new Tactical Traps Biometric Lock is Successfully Programmed!

Step 4: How the Bluetooth Lock Works

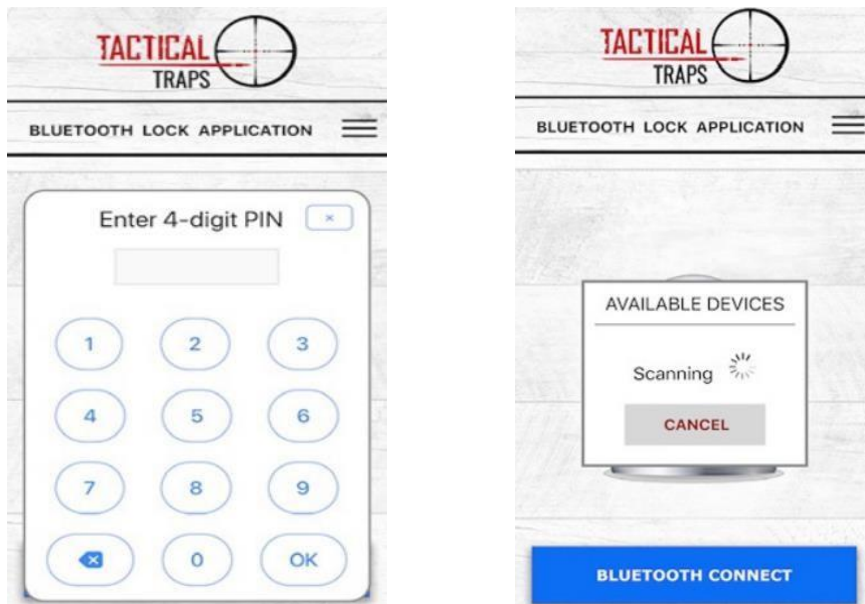

Your Tactical Mirror has been upgraded to our new Bluetooth lock and will open with your 4-digit PIN in our secured APP. You can the PIN taped to frame on a small yellow envelope. (Save the 4-digit pin on the envelope, you'll need this to connect to Bluetooth. **This 4-digit PIN** is also printed on the face of your lock, which is harder to see.)

1. Update your phones software if possible
2. Restart your phone
3. Turn on your Bluetooth
4. Go to the app store if you have an iPhone and search **Tactical Traps**. If you have an Android go to Google Play and search **Tactical Traps**. Download and install the app.
5. After you download the app, open it up and click the Bluetooth connect button. Your phone will scan for the lock. When it's found enter your 4-digit pin number. **You can find this number written on the yellow envelope or on the face of lock in the middle.**

Please double check that Location Services is turned on in your settings, which is required of any Bluetooth device to work, and that all permissions are turned on in the app settings.

6. Click the unlock button after the app is installed and Bluetooth is connected to open your frame.

Step 5: Batteries

The RFID lock runs on 4 AAA batteries that should be changed every six or so months, depending on use. To change the batteries simply remove the thumbscrew and battery cover plate on the RFID and open the battery compartment. Then remove the old batteries and replace with good quality new alkaline batteries.

IMPORTANT: When the lock battery gets low, you will hear a series of beeps when you unlock the unit. When you hear that series of beeps... it's time to change the batteries.

Step 6: Battery Backup Pack

If for some reason the batteries in your lock die before you change them - no problem! You can always get to your guns by using the battery backup pack that came with your purchase.

1. Place 4 AAA batteries inside your battery backup pack.
2. Locate the small auxiliary hole on the top left side of your frame
3. Plug the backup pack into the hole as tightly as it will fit.
4. Place your finger over the biometric reader on top of the mirror just like you normally would, and your frame will open.
5. When your frame is open, change your lock batteries

Step 7: Installation Instructions

1. Figure out where you want to hang the mirror. Some people put it in their bedroom. Others place it in the foyer by the door or even in a home office. The mirror will blend in as everyday furniture, so the possibilities are endless. Just make sure the wall is suitable for mounting the product, meaning 2x4 or 2x6 wood construction behind the drywall or plaster.

2. Find the two studs in your wall. Most likely it will be 16" on center. The unit is heavy and needs to be secured to studs in the wall.



If you don't have a stud finder, I suggest you purchase one at any home improvement store. My favorite is the magnetic stud finder. It runs about 7 bucks and does a better job than 99% of the more expensive electronic ones. Or you can use the magnet included with your unit to locate the screws (screws are where your studs are) in your wall.

3. Mark your stud locations on the wall and then transfer them onto your wood mounting plate of the unit. Drill pilot holes through the back plate in the marked locations using a drill bit no bigger than 1/8".

4. With help... pick up the unit and line up the pilot holes with the marks on the wall. Next, drive one wood screw (2-inch length min) as close to 1" inch from the top of the wood mounting plate as possible on both sides...hitting 2 studs. NOTE: Make sure the unit is level before screwing it to the wall on both sides.

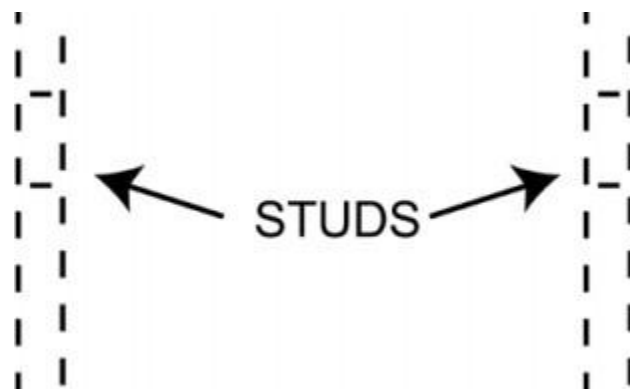

5. After you have the two top screws into both studs...take the remaining screws and secure a total of 4 screws into each stud. A total of 8 screws are used to hold the unit to the wall securely.

Step 8: Cutting the Foam to Fit Your Accessories



Note: For a video walkthrough go to: tacticaltraps.com/install

Lay the foam insert on the floor. Lay your gear on top. Push down snugly and trace them using a marker. Make sure if you're tracing your firearms that they are unloaded and the chamber is empty!

Next, cut out the foam carefully using a sharp and brand NEW razor/utility knife. It's recommended that you cut through at least $\frac{3}{4}$ of the foam for a handgun or a rifle.

The more time you take to do this correctly, the better your gear will fit. Don't be sloppy with this because the foam is designed to hold your gear in place when the unit closes. If the cuts are not precise you run the risk of your gear falling out when opening the unit. After you get everything cut out, remove the adhesive backing and carefully place it in your shelf making sure it's lined up correctly.

IMPORTANT: After the foam is cut and stuck to the unit...you need to secure a magnet (included) in the cavity the gun will be placed in. Simply, take one of the included screws and screw the magnet directly to the back plate. Place your gun inside and make sure it holds firmly before putting it in your unit.

If you're going to be mounting your rifle in the unit...make sure to use 2 magnets. Some rifles are not magnetic so we've included straps that can be used to secure it to the back plate. Simply screw through the strap into the back plate. Once both straps are secured...you can cut the strap to the length you want for your specific rifle.

Step 9: Safety Rules to Consider

1. Don't store your firearm with a live round in the chamber. Remember a Tactical Trap is not a safe; and although it's sturdy and well-built, it can be knocked off the wall or broken with enough force.

In the unlikely event of that happening your gun could send a round through your house after being dropped! Yes, many new firearms are equipped with a drop safety to prevent this, but this is still something you should consider especially if you live in a home with children. You can take back a lot of things in life but a bullet is not one of them. Please remember that and be responsible when you store your gear.

2. Our products are designed to work with standard 2x4 or 2x6 wood construction walls that are 16" on center. Does that mean the frame will not work on any other type of wall? Of course not, but the installation of this product on a different wall material (concrete, steel studs, etc.) will involve a different set of instructions and processes that vary depending on several factors. If you need help with this please send an email to support@tacticaltraps.com.

3. If you have children living in your home it would be a good idea to move your firearms into a locked safe when you are not home or by your Tactical Trap. Most children will not understand how to work the product, but it's better to be safe than sorry. Plus, the whole purpose of a Tactical Trap is for quick access and if you're not home or by the mirror... it makes no sense to leave your firearm inside of it.

Further, we believe in gun safety education for children living in the house. Hiding the gun from them at your home might be ok there, but what happens when they are at buddies' house? They need to know and respect firearms if you're going to keep them in the house because you never know when they might come across a loaded gun. Look at it as a kitchen knife. Most kids don't mess around with it because they know what it is and what its for. The problem is when their only experience with gun is TV and video games, they look at it as toy. Not good. Please be responsible and teach your children proper gun safety and rules for firearms.

Step 10: Troubleshooting

For trouble shooting videos specific to the mirror, please go to....

www.TacticalTraps.com/MirrorAdjustments